

INSTALLATION GUIDELINES

BEST LOCK EX-TREME®



Signature®
signaturefloors

BEST LOCK EX-TREME

INSTALLATION GUIDELINES

MOST IMPORTANT!

- The flooring material to be installed shall be allowed to acclimatise in their sealed boxes in the room or rooms it is to be installed into.
- The flooring material shall be acclimatised in this area for no less than 48 hours at a constant temperature of between 18°C and 28°C and a RH (relative humidity) of between 40% – 60%.
- The flooring must not be fixed at any point and must have suitable expansion gaps allowed in all areas. Expansion joints must be fitted in all doorways and in any width or length over 13 lineal meters.
- Once opened, the loose planks should be shuffled between boxes to ensure a uniform overall effect. The sub-floor to which the material is to be installed on must be structurally sound, dry and flat to a maximum of +/- 3mm in any 1m span.
- Ultimately the suitability of the installation conditions and area must be assessed and deemed suitable by the installer prior to the commencement of installation works.
- Signature Floors recognises the FCIA hand book - Timber & Hard flooring as industry best practice for the installation of all engineered and laminate floors, and as such adopt these guidelines as recommended practice.

General Conditions

A good installation is dependent on the points above and below being strictly followed. Failure to do so may result in a less than desirable outcome and could lead to flooring failure. By following our recommendations, you will ensure the flooring will perform as expected and remain trouble free for its lifetime. Signature Floors engineered wood flooring is an interior product only and must not be installed externally. Suitability for areas such as sunrooms should be confirmed with your Signature Floors representative.

SUB-FLOORS

Timber Sub-floors

Must be constructed according to local building codes, must be structurally sound and free from deflection and must be dry to less than 15% moisture. Loose or noisy boards should be fixed prior to commencement. The timber sub-floor shall be flat to a maximum of 3mm in any 1m span. Sanding and filling with a suitable compound may be required to achieve these requirements. A minimum of 450mm of unobstructed cross flow ventilation is necessary to ensure no build-up of moisture below the surface.

Concrete Sub-floors

Must be constructed according to local building codes, must be dry to less than 75% RH (relative humidity) when tested to ASTM F2170 or 5.5% moisture when tested using electrical resistance. Concrete must be level to +/- 3mm in any 1m span, A damp proof membrane, grinding and levelling with a suitable compound may be needed to achieve these requirements.

Underfloor Heating

Signature Floors floating floors are suitable for installation over Hydronic underfloor heating when they are installed using a direct stick method only. Please refer to our *Timber* Installation Guidelines for further information.

Underlay

All Signature Floors floating floors require an underlay to provide additional comfort and reduce noise. The underlay shall be no thicker than 2mm, of a closed cell construction. In most cases an underlay/moisture barrier will be the best choice.

Pre-Installation

Once material has been acclimatised and the installer is happy that installation is ready to go ahead, planks should be checked for obvious defects in suitable lighting. Signature Floors will not be liable for rectification costs for material installed with obvious defects.

The *Best Lock Ex-treme*® locking system contains a plastic strip which ensures an extremely strong and precise join for the life of the flooring. As you check each board for defects ensure the plastic strip is not damaged in any way as this may affect the strength of the join or make installation difficult.

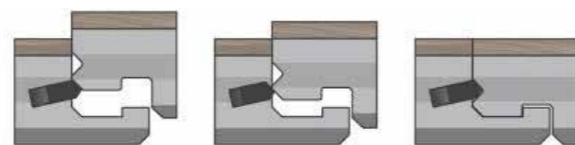

BEST LOCK EX-TREME

INSTALLATION GUIDELINES

Ensure the correct colour and quantity of material has been ordered and that all material is from the same batch.

Skirtings should be removed if possible and all door jambs should be undercut to allow the flooring to move freely.

If there is any doubt as to the dryness of the sub-floor, it is recommended to install 200uM builders plastic with all joints sealed with a waterproof tape to act as an additional vapour barrier.

Underlay Installation:

1. Roll out the underlay correct side up allowing approx 50mm extra up the walls which we will use to encapsulate the flooring later.



2. Tape the joints with vapour proof tape or the joiner provided.

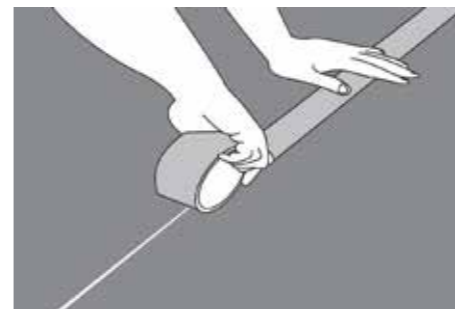

Flooring Installation:

1. Plank flooring should generally be installed lengthways to the longest area, measure the width of the room and ensure the final piece of plank will be wider than one half of the plank being installed. If this is not the case adjust the starting row to suit.

2. In the steps that follow, we'll ask you to lightly tap the boards with a mallet or hammer and tapping block only after the locks are engaged. Tapping lightly using your tools ensures the locks are engaged correctly and eliminates excess noise emitting from incorrectly engaged locks in the future.

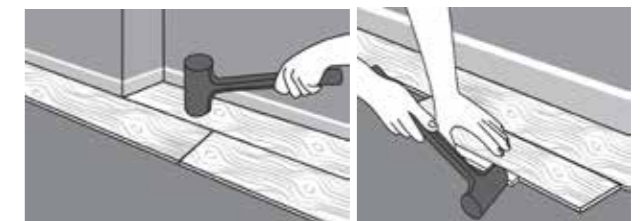

3. Start with the longest straightest wall working from left to right with the tongue facing the wall.

4. Fit the first row along the longest straightest wall. Starting in the top left hand corner, lay the planks end to end leaving a 10-12mm expansion gap with the tongue side facing the wall. Use the spacer wedges in the expansion gap to keep the planks in line.

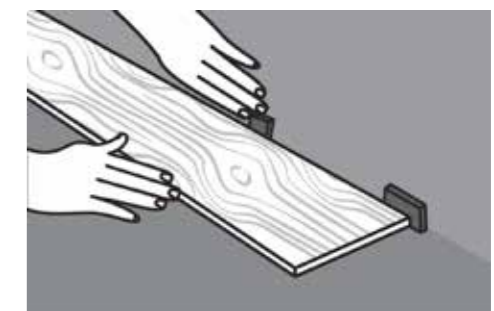

5. For the first row, position the left end lock of the second plank directly on top of the right end lock on the first plank then firmly press down to engage the *Best Lock Ex-treme*® locking system. The lock is engaged when you hear a click then lightly tap with your mallet to ensure the lock is engaged correctly.

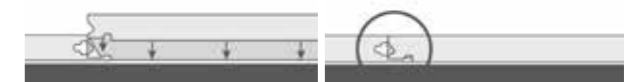

BEST LOCK EX-TREME

INSTALLATION GUIDELINES

6. As each plank is locked in, use the tapping block and mallet on the ends to ensure correct engagement. Cut the end piece allowing for the expansion gap. If the offcut piece is longer than 250mm, this can be used to start the second row and will help facilitate the recommended staggered effect.

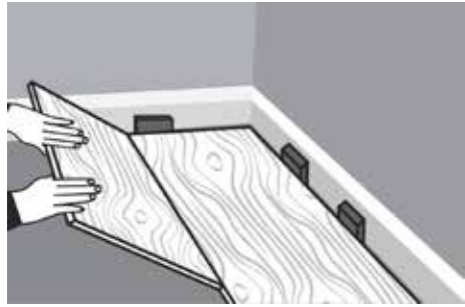

7. Commence locking in the second row by angling in the starting piece at approx 30°. Press it down until it clicks into place. Use your mallet and tapping block to ensure correct engagement of the locking system.

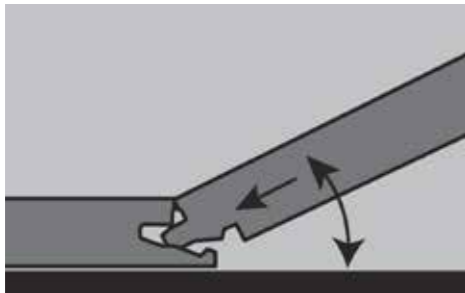

8. For the next piece, engage the angle lock but do not press down until it is directly over the top of the right hand end lock of the first piece. Once it is in position, press down firmly to lock both the ends and the length of the planks. Continue this way whilst using your tapping block and mallet on each plank to ensure correct engagement of the locking system.



9. Continue this way ensuring you allow a 10-12mm expansion gap around all fixtures and fittings until you reach the opposite side of the room.

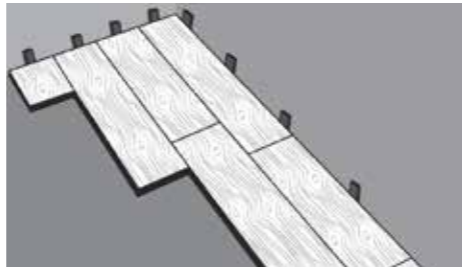

10. Measure the cut size for the final row and ensure you allow for the expansion gap. While fitting the final row, you may need the pull bar to ease the piece into place.

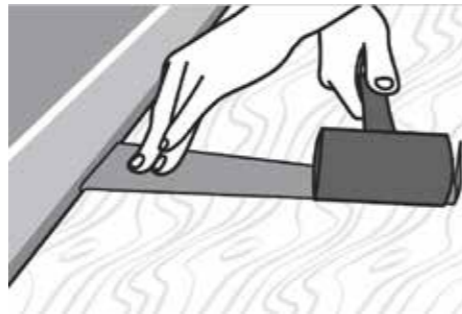

11. Once you have finished the final row cut the underlay to the height of the boards.

BEST LOCK EX-TREME

INSTALLATION GUIDELINES

12. Fit skirting or scotia to cover the expansion gap.

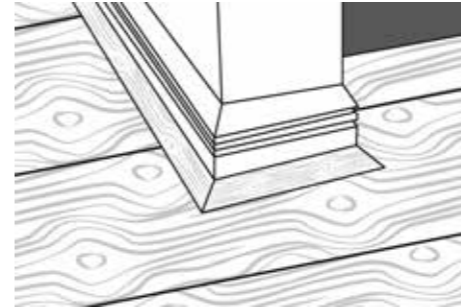

Best Lock Ex-treme- Installation Guidelines

Document ID: 100080

Revision No: 02

Date modified: 19/11/2018

Signature Floorcoverings Pty Ltd
ABN 45 007 172 938
PO Box 1122 Epping 3076 VIC
13 Wurundjeri Drive, Epping 3076 VIC Australia
Tel: 03 9401 0888 Fax: 03 9401 0866
www.signaturefloors.com.au

PO Box 527, Silverdale, Auckland 0944
7B Furnace Place, Silverdale, Auckland 0932
Tel: 0800 150 555
www.signaturefloors.co.nz

